

Capital Gateway Rooftop Terrace Washington, D.C.

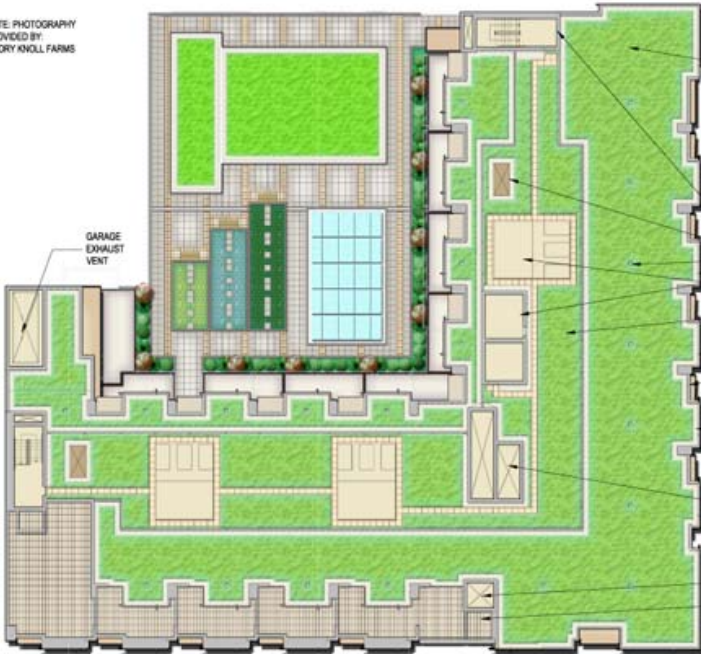

NOTE: PHOTOGRAPHY
PROVIDED BY:
EMORY KNOLL FARMS



Above: This mixed use building is currently undergoing final engineering plan approval and in the process of obtaining its building permits and begins construction Spring 2009.
Right: Located at the corner of Florida Avenue, 4th Street, and Morse Street this building will be the first structure built as part of the larger New Town at Capital City Market.

Date Installed: In Design

System Type: Extensive Built Up Assembly on 12th floor and the exercise room, Intensive and semi-intensive planters in the courtyard.

Roof Size: 32,600 sq. ft.
(18,450 sq. ft. of vegetated roof)

Plant Material: 4 in. deep extensive assembly, perennials, shrubs, and trees in the planters.

Architect: McKissack & McKissack

Contractor: Not Selected

Client: Sang Oh Choi/Apollo Real Estate

Address: 300 Morse Street, N.E.
Washington, DC

Website: <http://washington.bizjournals.com/washington/stories/2007/07/02/story1.html>



Left: Located approximately 1/4 mile from the New York Avenue metro station this transit oriented development will bolster economic development right outside of the NOMA redevelopment district.

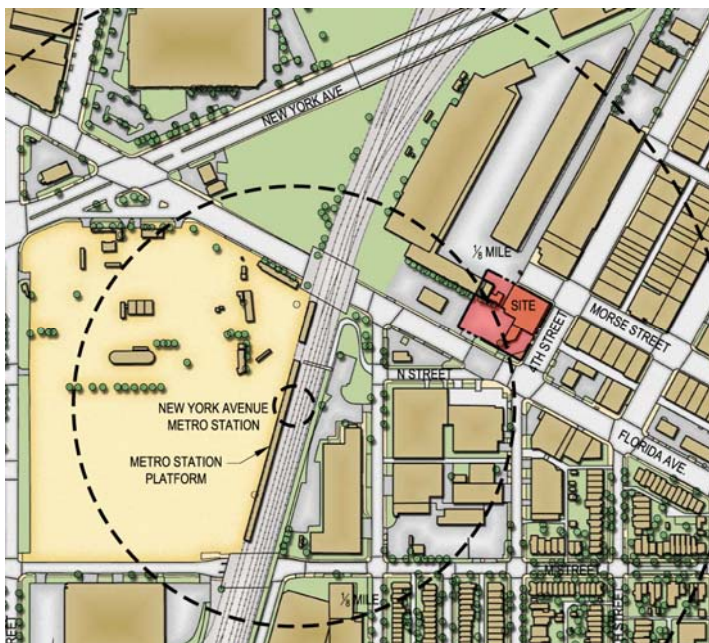

For additional, questions concerning the design of this system please contact the project manager (Gregory Long) at 301.452.1144.